

C-100BAF-(AD)DS

SELF-CONTAINED CUBELET WITH BUILT-IN STORAGE BIN (ADA Compliant with Customized Door System)

Item # _____

Project: _____

Qty: _____

*AutoCad available on KCL

C-100BAF-(AD)DS

I/11

Item # 13277

CUBELET DIMENSIONS

W x D x H

C-100BAF

14^{7/8} x 22^{5/8} x 33^{1/2}

C-100BAF-AD

14^{7/8} x 22^{5/8} x 31^{1/2}

C-100BAF-DS

14^{7/8} x 22^{5/8} x 33^{1/2}

C-100BAF-ADDS

14^{7/8} x 22^{5/8} x 31^{1/2}

*DS - Designed to accommodate custom cabinetry to affix to stainless door.

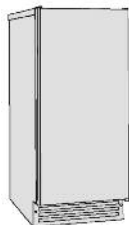

C-100BAF(-DS)

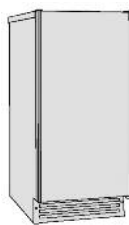

C-100BAF-AD(DS)

C-100BAF

Air-Cooled
Shown

C-100BAF-AD

Air-Cooled
ADA Compliant Unit



C-100BAF-DS*

Air-Cooled
Shown
with Custom Cabinetry

C-100BAF-ADDS*

Air-Cooled
ADA Compliant Unit



*Customer responsible for providing cabinetry

C-100BAF & C-100BAF-DS

- Undercounter design is less than 34 inches tall

C-100BAF-AD & C-100BAF-ADDS

- Undercounter design is less than 32 inches tall, which complies with the Americans with Disabilities Act (ADA)

C-100BAF(-DS) & C-100BAF-AD(DS)

- Up to 92 lbs. of ice production per 24 hours
- UL approval for outdoor use
- Up to 22 lbs. of built-in storage capacity
- Power switch accessible without panel removal
- Easily disassembled water circuit for easy cleaning
- Front in, front out airflow
- Fewer moving parts for longer life
- Swing style reversible door
- Side and top trim kit available
- Drain pump accessory - HS-0248
- R-134A Refrigerant



ISO9001-15014:2001

Warranty

Valid in United States, Canada, Puerto Rico, & U.S. Territories. Contact factory for warranty in other countries.

Two Year - Parts & Labor on entire machine.

One Year - HS-0248 Drain Pump Assembly - Parts & Labor.



C-100BAF-(AD)DS SELF-CONTAINED CUBELET WITH BUILT-IN STORAGE BIN

DIMENSIONS W x D x H

C-100BAF / C-100BAF-DS
14^{7/8} x 22^{5/8} x 33^{1/2}

C-100BAF-AD / C-100BAF-ADDS
14^{7/8} x 22^{5/8} x 31^{1/2}

- Air-cooled
- ADA compliant

AIR-COOLED

| Water Temp ° F. | 50° | 70° | 90° |
|-----------------|-----|-----|-----|
| Air Temp ° F. | | | |
| 70° | 92 | 89 | 84 |
| 80° | 81 | 71 | 66 |
| 90° | 66 | 62 | 57 |

UTILITY CONSUMPTION (AIR 70°F/WATER 50°F)

| Model Number | KWH per 100 LBS. | Potable Water Gal. per 100 lbs. | Condenser Water Gal. per 100 lbs. |
|-----------------|------------------|---------------------------------|-----------------------------------|
| C-100BAF-(AD)DS | 12.1 | 12 | N/A |

SPECIFICATIONS

| Model Number | Condenser | Amperage | Min. Circuit Ampacity | Shipping Weight |
|-----------------|------------|----------|-----------------------|-----------------|
| C-100BAF-(AD)DS | Air-Cooled | 4.0 | 15 | 115 lbs.* |

* Without pallet

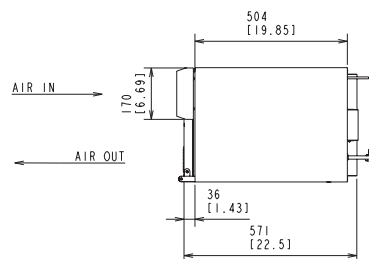

TOP DIMENSIONS

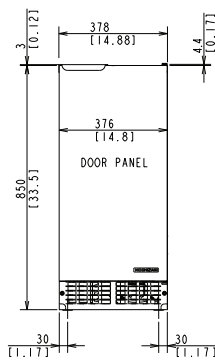

FRONT DIMENSIONS

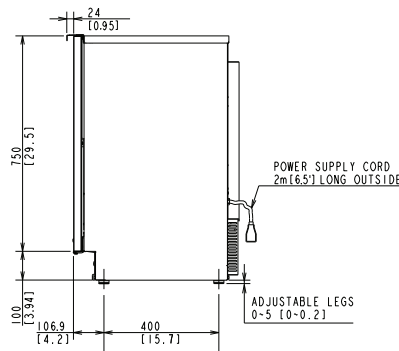

SIDE DIMENSIONS

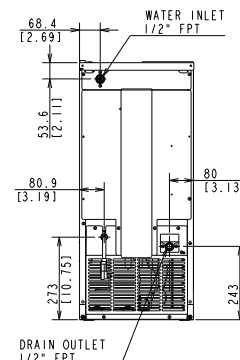

BACK DIMENSIONS

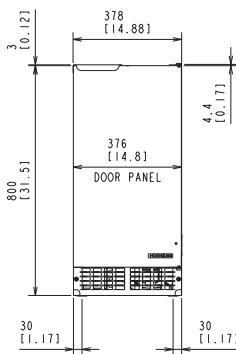

FRONT DIMENSIONS
(ADA compliant unit)

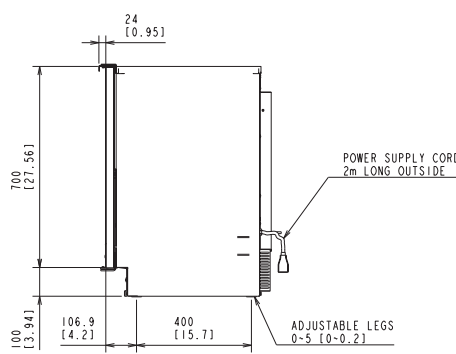

SIDE DIMENSIONS
(ADA compliant unit)

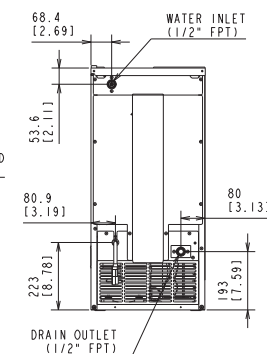

BACK DIMENSIONS
(ADA compliant unit)

ELECTRICAL & PLUMBING/C-100BAF-AD(DS)

- 115V/60/1
- 15 amp Max Fuse/HACR Breaker Size
- 1/2" FPT Water Inlet
- 1/2" FPT Drain

OPERATING LIMITS

- Ambient Temp Range 45 - 100°F
- Water Temp Range 45 - 90°F
- Water Pressure 7 - 113psig
- Voltage Range 104 - 127V



© HOSHIZAKI AMERICA, INC.

618 Hwy. 74 S., Peachtree City, GA 30269

TEL 1-800-438-6087

FAX 1-800-345-1325

www.hoshizaki.com

Printed in U.S.A.

